



PUI audio



Data Sheet

AI-1433-TWT-R

Features:

- Piezo Indicator
- 12Vdc rated, 3300Hz
- Thru-Hole Type, wave solder and washable

Specifications

Parameters	Values	Units
Rated Voltage	12	VDC
Operating Voltage Range	3-18	VDC
Current Draw at Rated Voltage	7(Max.)	mA
Minimum SPL @ 10cm	80	dBA
Resonant Frequency	3300 ± 300	Hz
Tone or Pulse Rate	Single Continuous	-
Housing Material	Noryl	-
Terminal Material	Tin plated Copper(DSn)	-
Weight	1	Grams
Acceptable Soldering Methods	Hand Solder, Wave Solder	See page 3 for soldering information
Environmental Compliances	ROHS/REACH	Exemption 7c-1
Moisture Sensitivity Level	-	-
Storage Temperature	-30 to 80	°C
Operating Temperature	-20 to 70	°C

Measurement Method (12Vdc, 10cm distance)

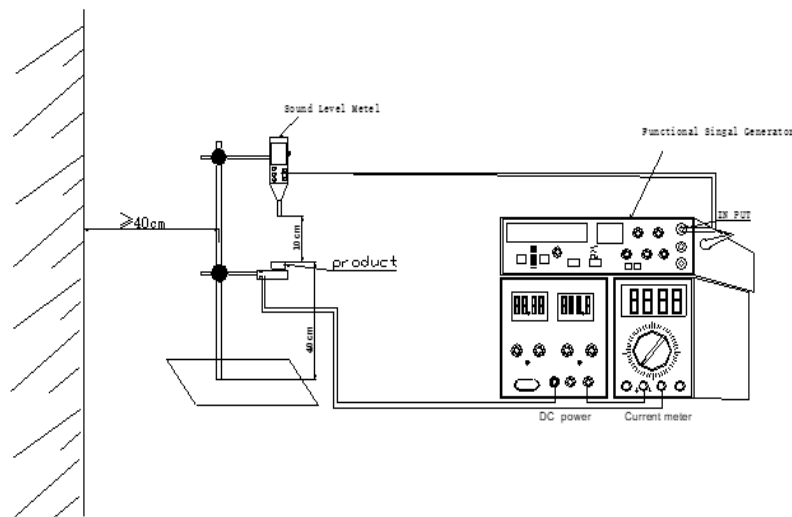

Typical SPL vs Input Voltage

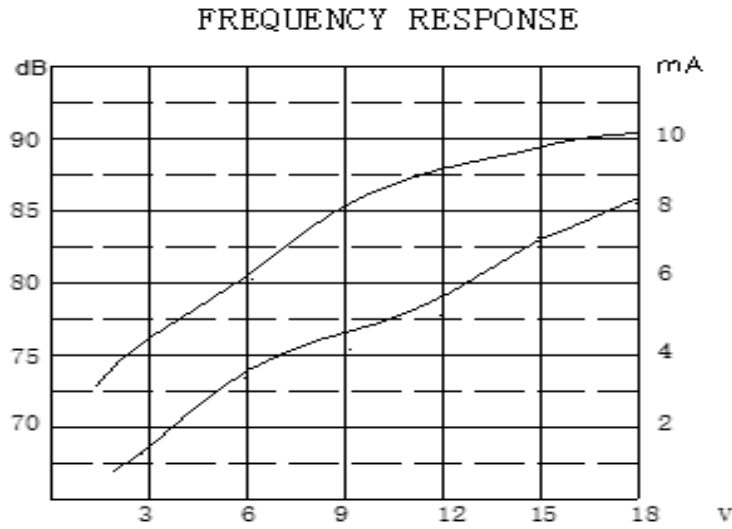

Recommended Wave Solder Profile

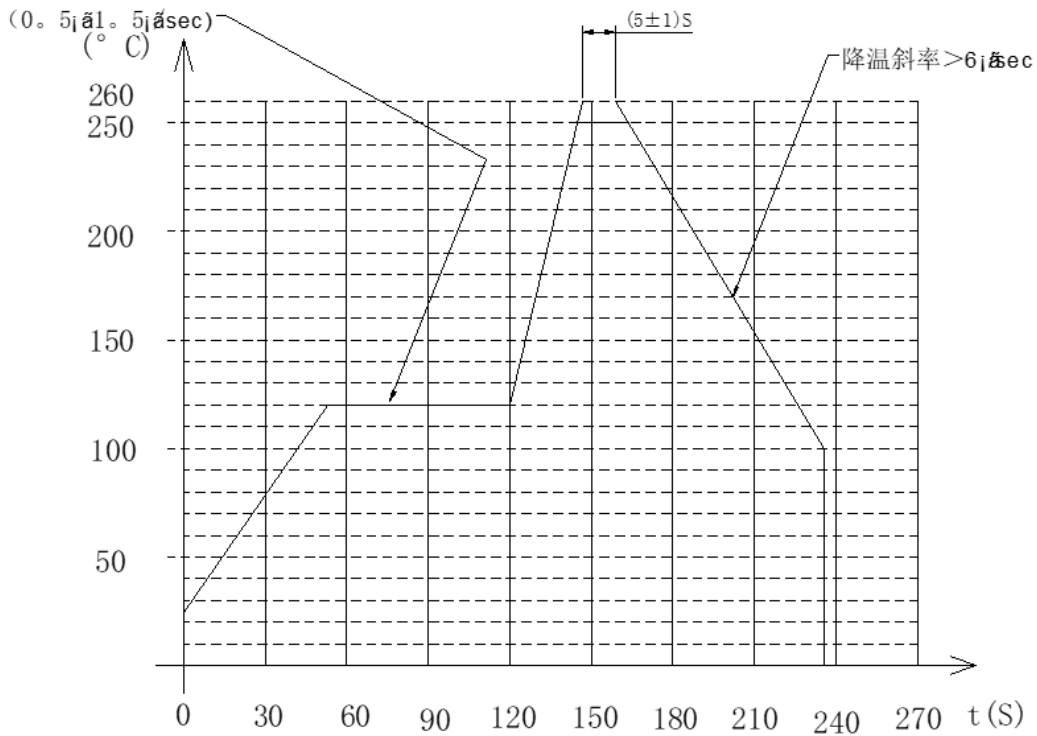

Reliability Testing

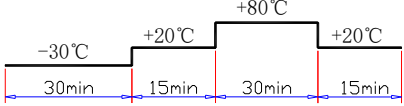
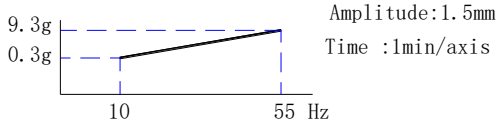
Type of Test	Test Specifications
High Temperature Test	Storage in $+80^{\circ}\text{C} \pm 2^{\circ}\text{C}$ test box for 96 hours, then expose to the room temperature for 2 hours without applying power.
Low Temperature Test	Storage in $-30^{\circ}\text{C} \pm 2^{\circ}\text{C}$ test box for 96 hours, then expose to the room temperature for 2 hours without applying power.
Humidity Test	Storage in $+40^{\circ}\text{C} \pm 2^{\circ}\text{C}$ 90-95%RH test box for 96 hours, then expose to the room temperature for 2 hours without applying power.
Temperature Cycle Testing	 <p>Make this test for 5 cycles without applying power, then expose to the room temperature for 2 hours.</p>
Vibration Test	 <p>Make this test for the directions of X, Y, Z for 2 hours each (total 6 hrs).</p>
Drop Test	Free drop a unit from the height 70cm to the surface of 10mm thick board, three directions(X,Y,Z).

***After tests, Part shall pass SPL within $\pm 5\text{dB}$.**

Dimensions

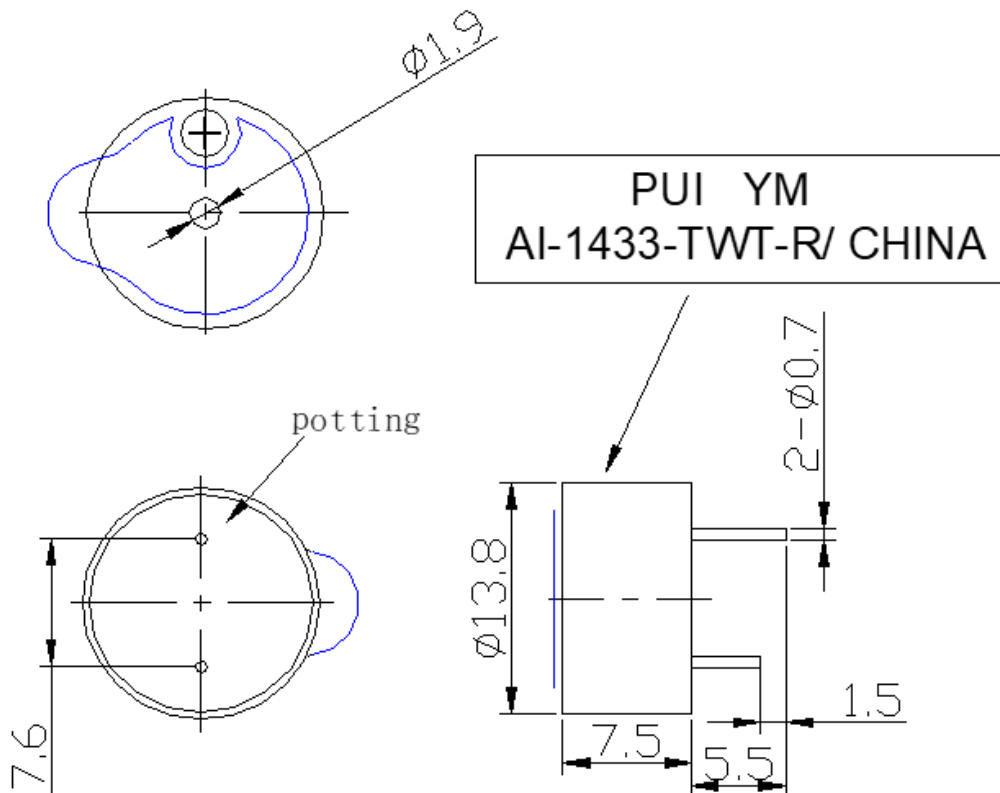

Packaging

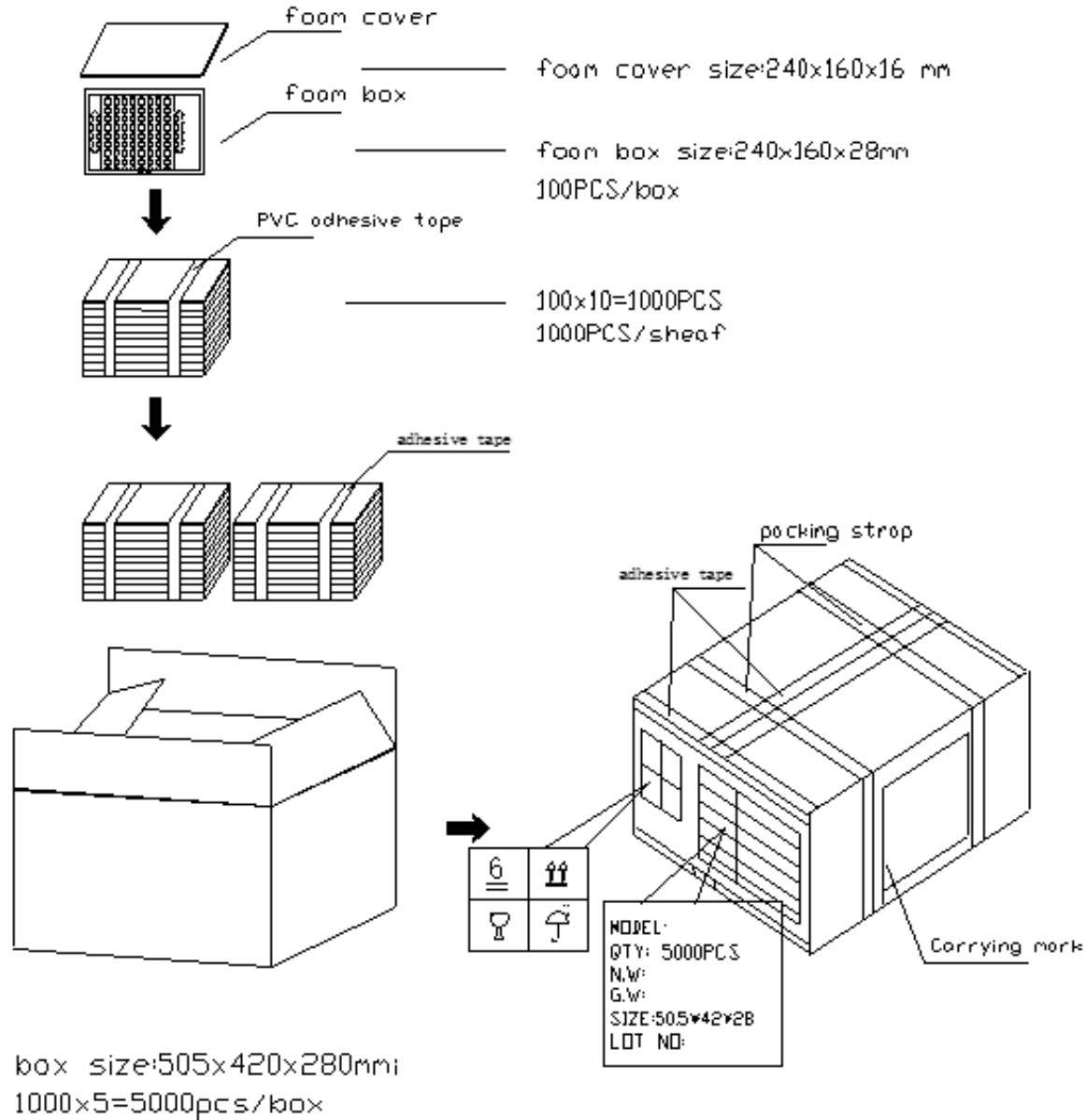

Specifications Revisions

Revision	Description	Date	Approved
-	Released from Engineering	11/08/2005	-
A	Revised Pin Length Dimension	11/15/2007	RW
B	Revised to 3D Template	11/15/2007	BR
C	Update Spec Format, Add details for Reliability, Packaging, etc.	06/25/2024	ML

Note:

- Unless otherwise specified:
 - All dimensions are in millimeters.
 - Default tolerances are $\pm 0.5\text{mm}$ and angles are $\pm 3^\circ$.
- Specifications subject to change or withdrawal without notice.