



PUI audio



a

Data Sheet

AT-1436-TWT-R

Features:

- Top-Firing Piezo Transducer
- 5Vp-p rated, 3600Hz
- Wave Solder and Wash Allowed

Specifications

Parameters	Values	Units
Rated Voltage	5	Vp-p
Operating Voltage Range	1 ~ 20	Vp-p
Current Draw at Rated Voltage	3	mA
Capacitance at 120Hz	13,000 ± 30%	pF
Minimum SPL @ 10cm	80	dBA
Resonant Frequency	3600 ± 500	Hz
Housing Material	Noryl	-
Terminal Material	Sn Plated Copper	Red Copper
Weight	1	Grams
Acceptable Soldering Methods	Hand Solder, Wave Solder	-
Environmental Compliances	ROHS/REACH	Exemption 7c-1
Storage Temperature	-30 ~ 80	°C
Operating Temperature	-20 ~ 70	°C

Measurement Method (10cm, 5Vp-p, 3600 Hz square wave)

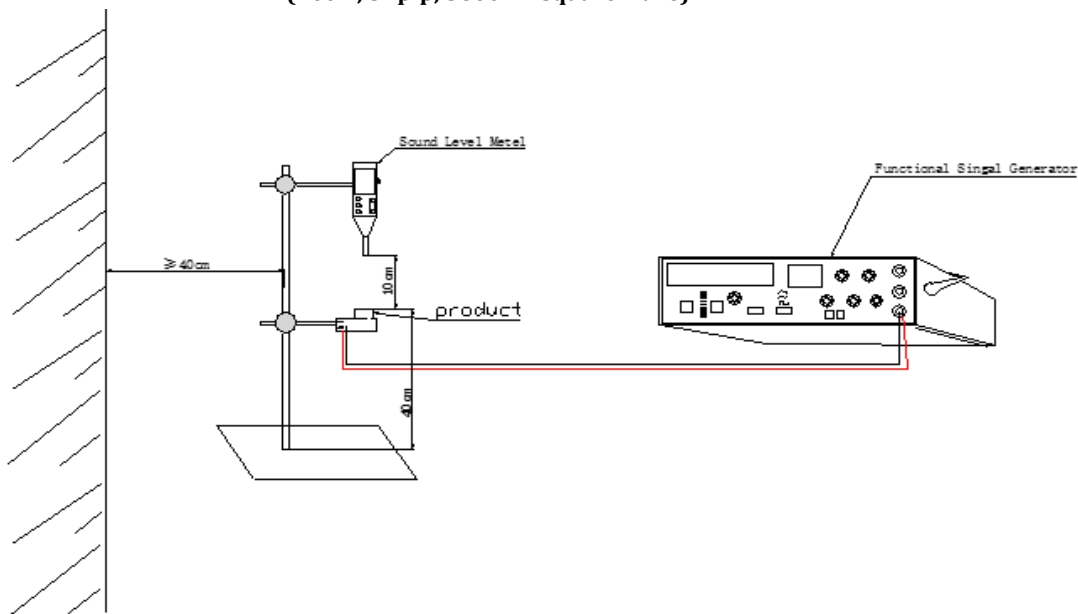

Typical Frequency Response (5Vpp, 3600Hz, 10cm)

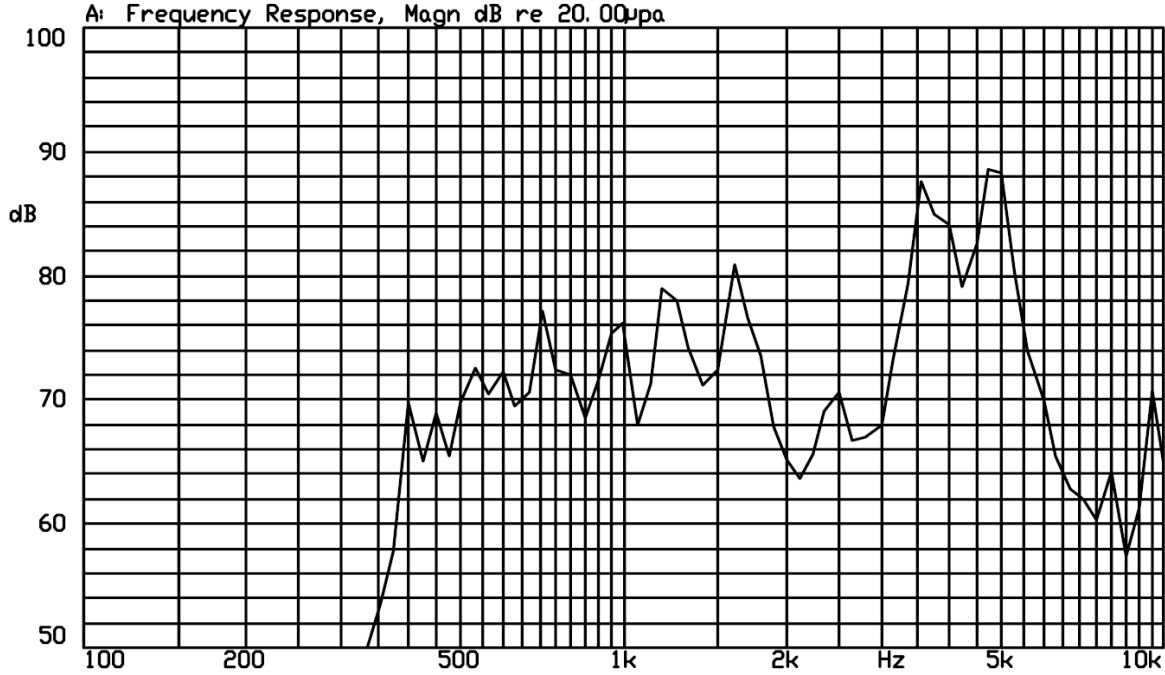

Reliability Testing

Type of Test	Test Specifications
High Temperature Test	Storage in $+70^{\circ}\text{C} \pm 2^{\circ}\text{C}$ test box for 96 hours, then expose to the room temperature for 2 hours without applying power.
Low Temperature Test	Storage in $-30^{\circ}\text{C} \pm 2^{\circ}\text{C}$ test box for 96 hours, then expose to the room temperature for 2 hours without applying power.
Humidity Test	Storage in $+40^{\circ}\text{C} \pm 2^{\circ}\text{C}$ 90-95%RH test box for 96 hours, then expose to the room temperature for 2 hours without applying power.
Temperature Cycle Testing	<p>Make this test for 5 cycles without applying power, then expose to the room temperature for 2 hours.</p>
Vibration Test	<p>Amplitude: 1.5mm Time : 1min/axis</p> <p>Make this test for the directions of X,Y, Z for 2 hours each (total 6 hours).</p>
Drop Test	Free drop a unit from the height 70cm to the surface of 10mm thick board ,three directions(X,Y,Z).

Parts pass after tests and SPL within $\pm 5\text{dB}$

Dimensions

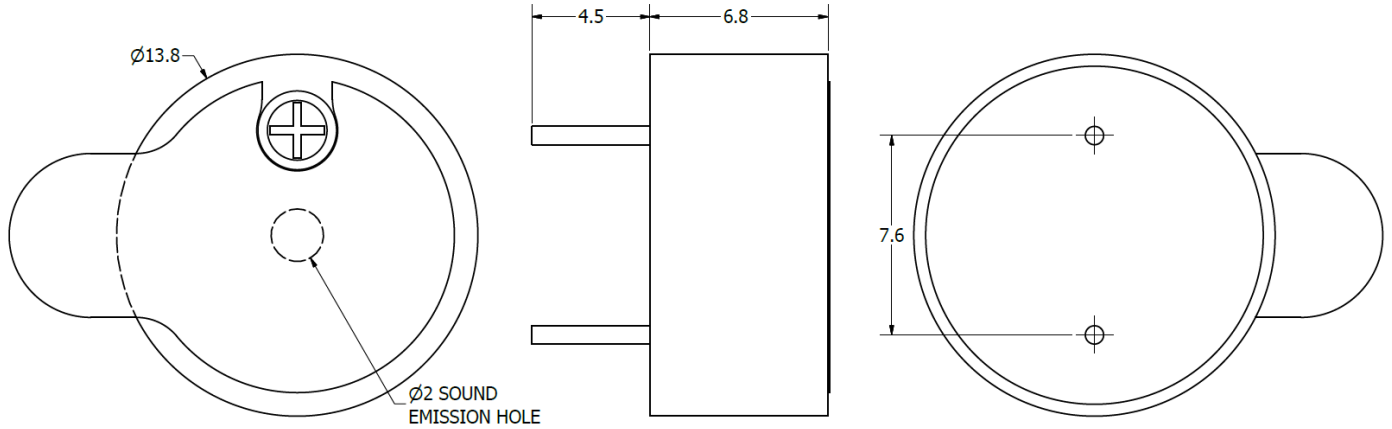

Packaging

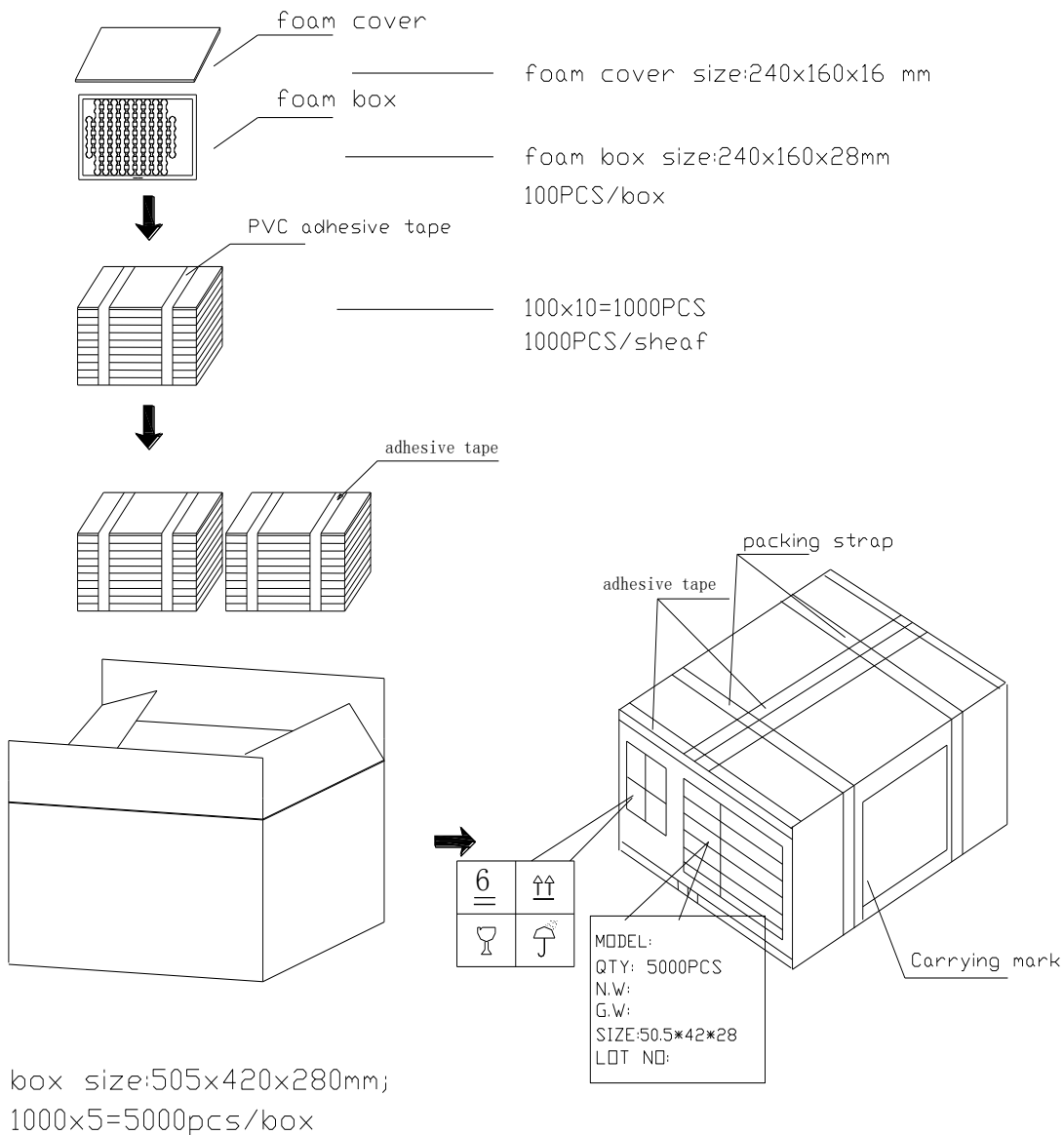

Specifications Revisions

Revision	Description	Date	Approved
-	RELEASED FROM ENGINEERING	11/07/2005	-
A	REVISED TO INVENTOR 3D DRAWING TEMPLATE	04/16/2008	BR
B	REVISED CAPACITANCE	03/25/2019	MV
C	Update Spec Format, Add Details for Packaging, Reliability, Etc.	09/17/2024	ML

Note:

1. Unless otherwise specified:
 - A. All dimensions are in millimeters.
 - B. Default tolerances are $\pm 0.5\text{mm}$ and angles are $\pm 3^\circ$.
2. Specifications subject to change or withdrawal without notice.