

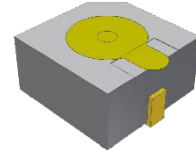

PUIaudio



Data Sheet

SMI-1324-TW-5V-3-R

Features:

- Electro-Mechanical Buzzer
- 5Vdc, 2400Hz
- Reflow Allowed, Washing NOT Allowed
- Tape and Reel

Specifications

Parameters	Values	Units
Rated Voltage	5	VDC
Operating Voltage Range	3 - 8	VDC
Current Draw at Rated Voltage	30(Max.)	mA
Minimum SPL @ 10cm	85	dBA
Resonant Frequency	2400 ± 500	Hz
Tone or Pulse Rate	Continuous	-
Housing Material	PPS	-
Terminal Material	Au Plated Brass	-
Weight	2.0	Grams
Acceptable Soldering Methods	Hand Solder, Reflow Solder	See following pages for details
Environmental Compliances	RoHS/REACH	-
Moisture Sensitivity Level (MSL)	Level 2	-
Storage Temperature	-40 ~ 80	°C
Operating Temperature	-30 ~ 70	°C

Measurement Method (3Vdc, 10cm)

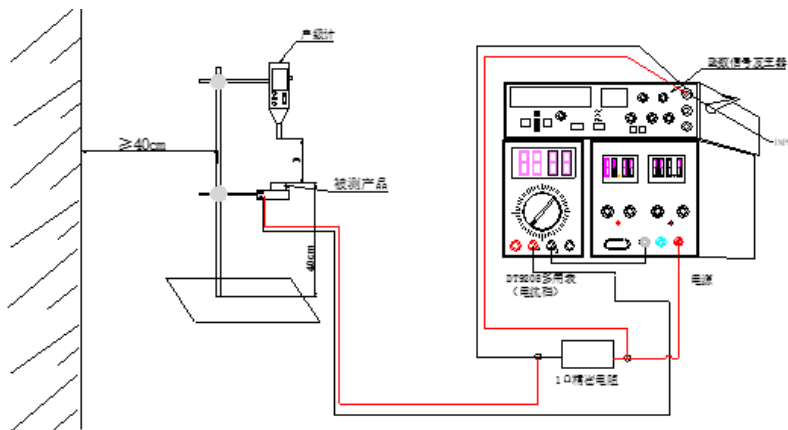

Typical SPL vs Input Voltage

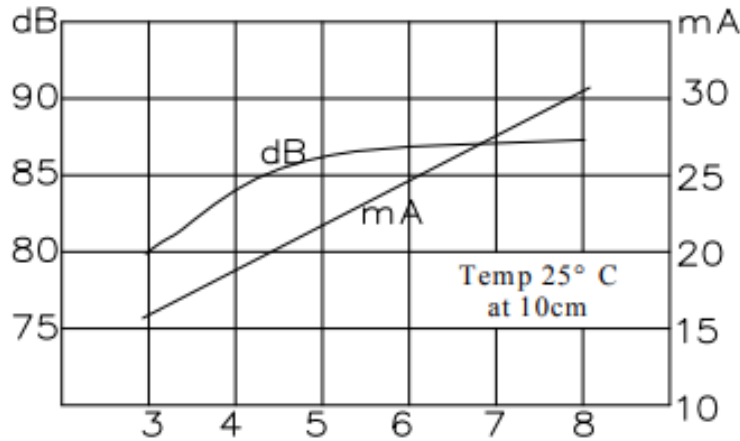

Reliability Testing

Type of Test	Test Specifications
High Temperature Test	4 hours at $85\pm 2^{\circ}\text{C}$, then 2 hours at room temperature.
Low Temperature Test	4 hours at $-40\pm 2^{\circ}\text{C}$, then 2 hours at room temperature.
Humidity Test	24 hours at 40°C with relative humidity at 90-95%, then 4 hours at room temperature.
Temperature Cycle Testing	$-40\pm 2^{\circ}\text{C}$ for 30 minutes, then at room temperature ($+20^{\circ}\text{C}$) for 15 minutes, then at $+80\pm 2^{\circ}\text{C}$ for 30 minutes, then room temperature ($+20^{\circ}\text{C}$) for 15 minutes. 5 cycles.
Vibration Test	Amplitude of 1.5mm with 10 to 55 Hz band of vibration frequency to each of 3 perpendicular directions for 2 hours.
Drop Test	Drop on a hard wood board of 5cm thick, any directions, 6 times, at the height of 80cm.
Load Test	If applicable, state the conditions of the load test

After Tests, allow part to rest for 2hrs before retesting. Part shall be within $\text{SPL} \pm 10\text{dB}$.

Recommended Reflow Profile

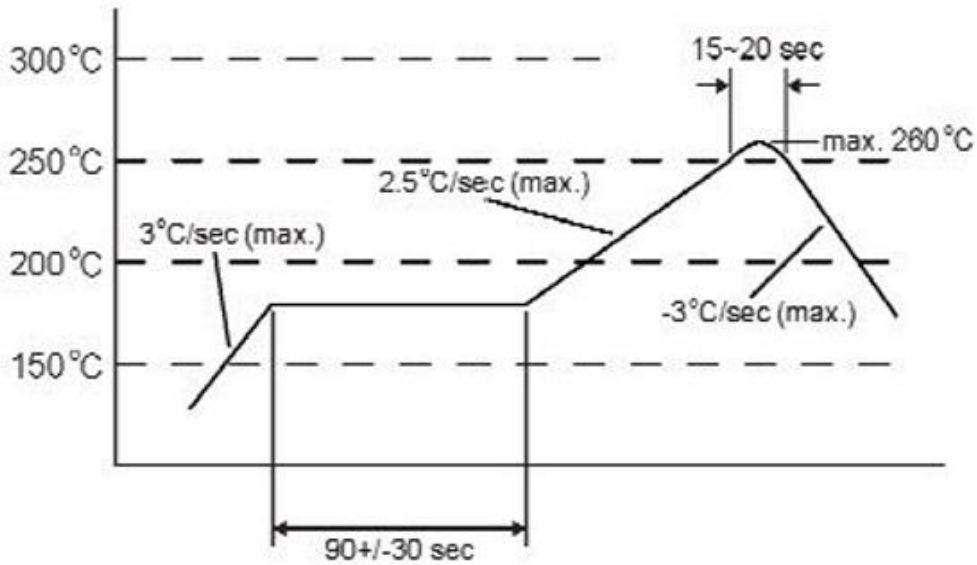

Dimensions

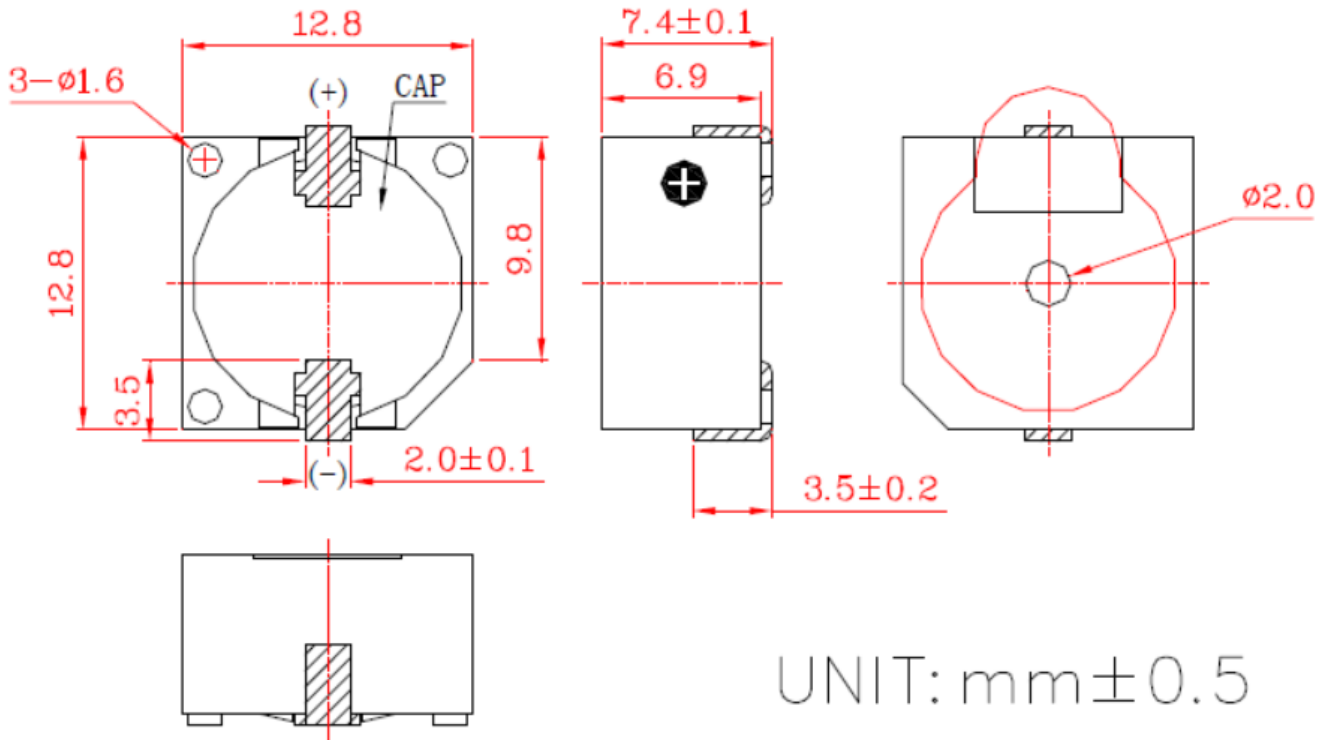

Recommended Land Pattern*

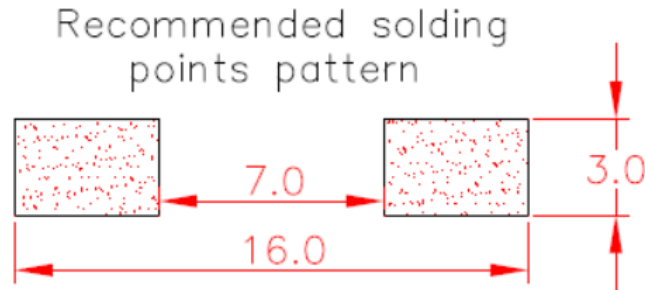

*This land pattern is advisory only and its use or adaptation is entirely voluntary. PUI Audio disclaims all liability of any kind associated with the use, application, or adaptation of this land pattern.

Packaging 300pcs per reel

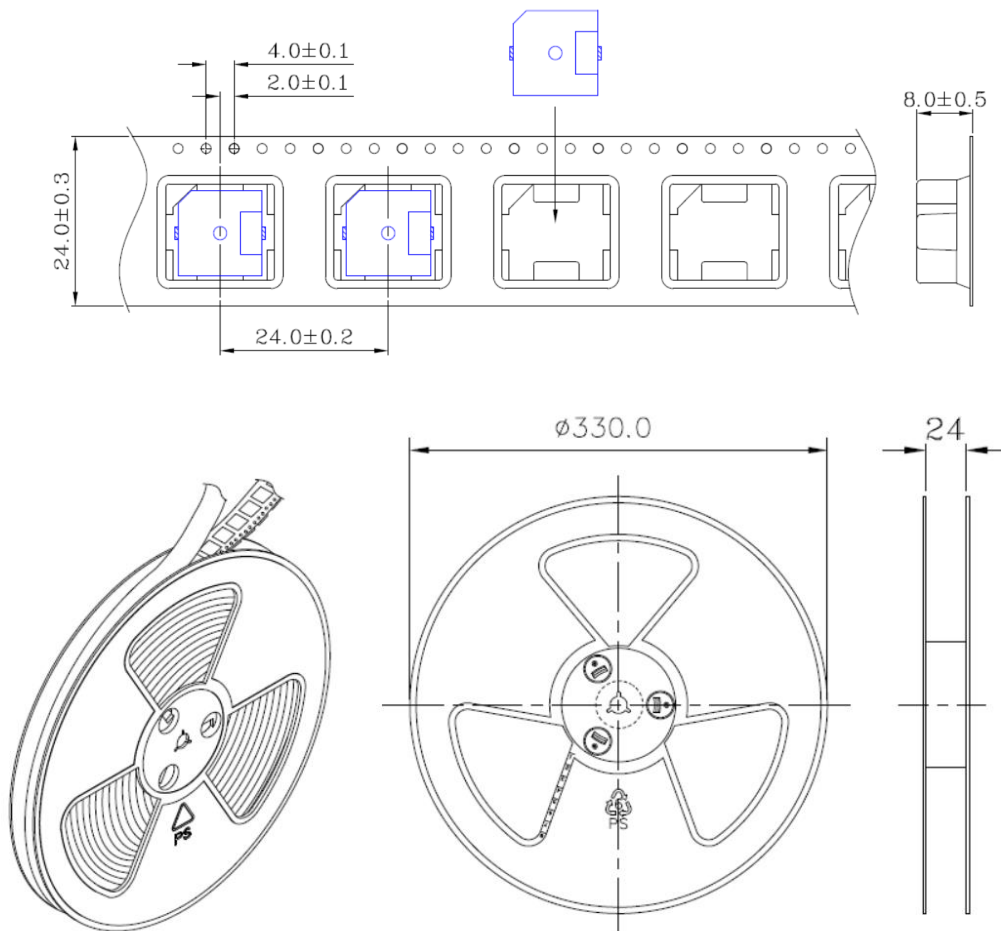

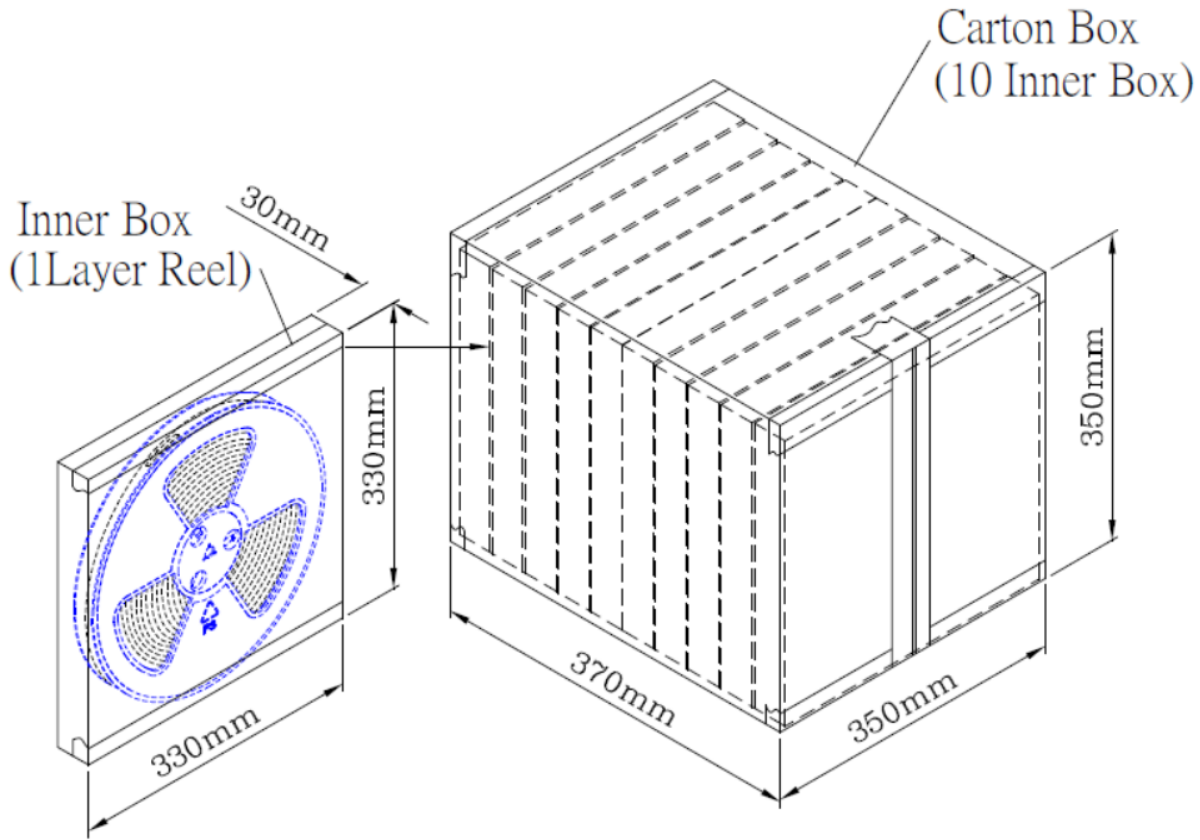

3000pcs per master carton

Specifications Revisions

Revision	Description	Date	Approved
-	Released from Engineering	07/17/2008	-
A	Revised operating voltage range	11/03/2009	BR
B	Revised to inventor 3-D drawing template	05/28/2010	BR
C	Revised part height dimensions	07/28/2010	BR
D	Revised length and width	10/29/2012	BR
E	Revised voltage range and temperature specifications	02/28/2020	MV
F	Updated Spec Format and Drawing Image. Add Details for Reliability, Packaging, etc., Revised Temperature Ranges, Revised SPL	05/15/2024	ML

Note:

1. Unless otherwise specified:
 - A. All dimensions are in millimeters.
 - B. Default tolerances are $\pm 0.5\text{mm}$ and angles are $\pm 3^\circ$.
2. Specifications subject to change or withdrawal without notice.